



Rochester Cathedral Explorer Trail

Answer sheet



This sheet will help you to explore the Cathedral with your group. The answers to the Explorer Sheet are given, as well as discussion points to extend learning. On the reverse is a map to help you to find your way around the building.

<p><u>The Font</u></p> <p>New members to the church are welcomed by baptism. This can occur at any age. The Paschal candle usually stands beside the font and is lit during the baptism ceremony. Water is used in baptism to represent a clean start.</p>	<p><u>Stained Glass Window of St Luke</u></p> <p>St Luke was one of the Gospel writers. The others were Matthew, Mark and John. Each has his own symbol. St Luke's is a bull. His bull is purple in this window possibly representing the holy sacrifice of Jesus.</p>
<p><u>The Lady Chapel</u></p> <p>This Chapel is dedicated to Mary, the mother of Christ. She is shown in all of the lower windows and in the upper window on the far left. Mary's halo is red in this window and then changes to gold when she becomes a mother.</p>	<p><u>The Lady Chapel</u></p> <p>The windows tell the story of the life of Christ. The children should quite easily be able to spot the Christmas and the Easter windows. The Christmas window also shows the shepherds.</p>
<p><u>The Green Men</u></p> <p>Green Men are faces surrounded by leaves. They symbolise new life and creation. Other Green Men can be found carved into the stone of Hamo de Hythe's tomb at the base of the Pilgrim Steps.</p>	<p><u>The Fresco</u></p> <p>The upper picture shows the baptism of Jesus by John the Baptist. The lower left hand picture shows King Ethelbert being baptised, the lower right shows the baptism of the Kentish folk. Ethelbert was the first English King to be baptised.</p>
<p><u>The North Quire Transept</u></p> <p>The William of Perth window is situated behind the tomb of Walter de Merton. It is the third small window along from the left. There is a shell on his bag and also one on his hat. The scallop shell is the sign of a Pilgrim.</p>	<p><u>The Quire</u></p> <p>The coats of arms are those of past bishops of Rochester. Samuel Horsley's can be found on the left hand side as you face the high altar. The picture shows horses (possibly a play on his name)!</p>
<p><u>The Cathedra</u> - The Bishop's Throne</p> <p>A shepherd carries a crook like the Bishop's crozier. This reminds the Bishop that he should act like a "Good Shepherd" caring for people in his area. The hook is in the shape of the letter "R" for Rochester!</p>	<p><u>The High Altar</u></p> <p>The service of Holy communion is celebrated here. The picture carved in stone behind the altar is "The Last Supper". Can the children work out why this picture is here?</p>
<p><u>The Garden</u></p> <p>The statue is in the centre of the garden it depicts a mother and a child, Mary and Jesus. This area was the centre of the Benedictine monastery which was situated here in medieval times.</p>	<p><u>The Crypt</u></p> <p>This basin is called a piscina. It would once have held water for the priest to wash his hands and holy vessels during the communion service. There are several of these in the crypt. They show us where chapels used to be.</p>

Rochester Cathedral

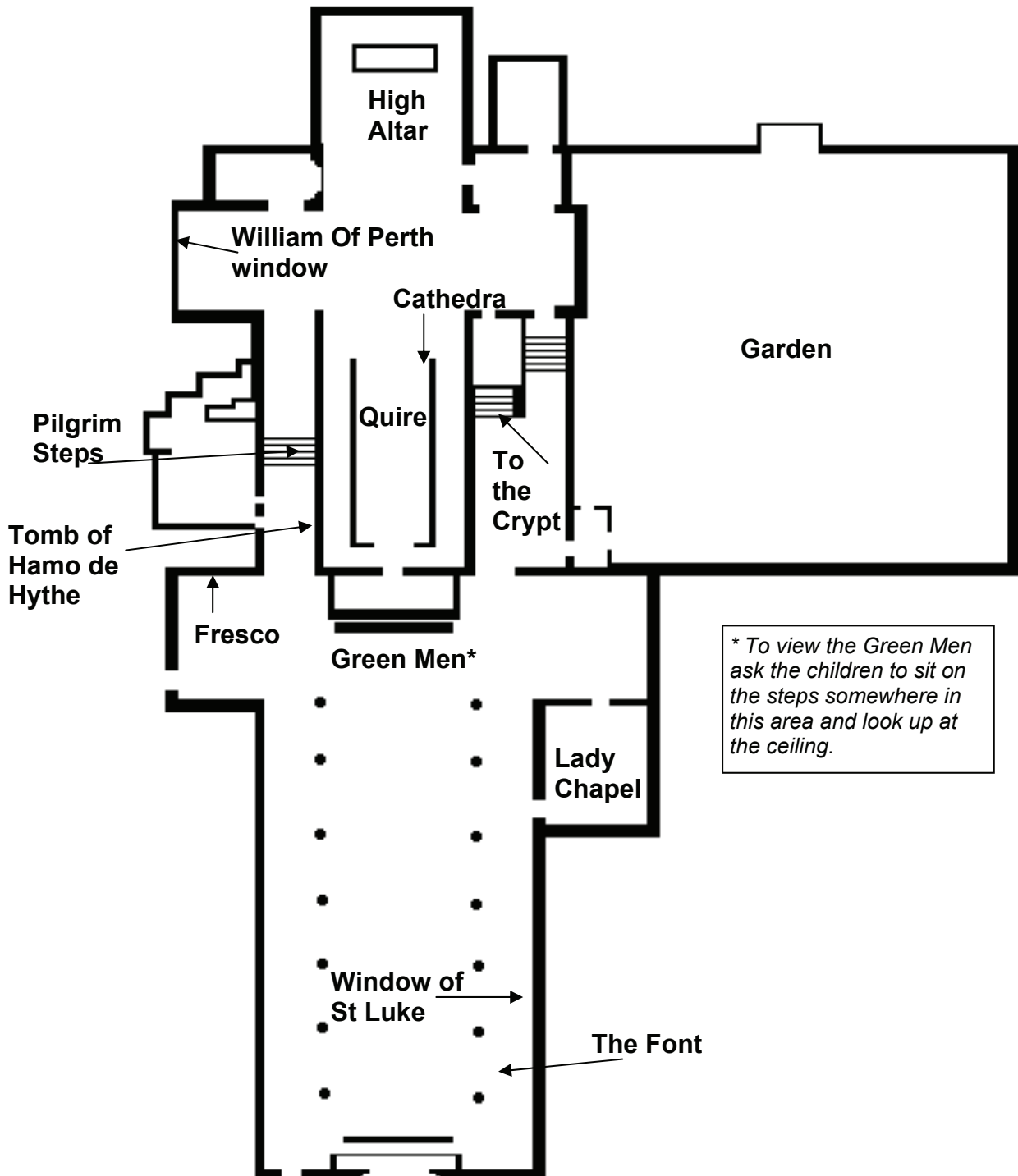

Once your group has explored the Cathedral you may like to sit quietly soaking up the atmosphere and enjoying the space. The children may like to light a candle and say a quiet prayer.